

MODIFICATIONS	
Working Capacity Upgrade to 16mm sq.	2/94
New components P/N's 629, 630, 631, 633, 634, 635 for improved basket making.	9/98
Split body with fixed feet.	03/02
Pt. no. 889 replaces 488. Pt. no. 890 replaces 630	03/04
Pt. no. 967 added to slide Pt. no. 890	09/09
Pt. no. 1731 replaces 807 Pt. no. 1732 replaces 809	01/13
Pt. no. 1800 added	04/18
MASTER TWISTER	
Part No.27	
Version No.3	
 J & C R WOOD HULL ENGLAND	
REF: TRIMP11/93	DATE: 11/93
DTP: SPDPMTD.PPP	

NOT TO SCALE

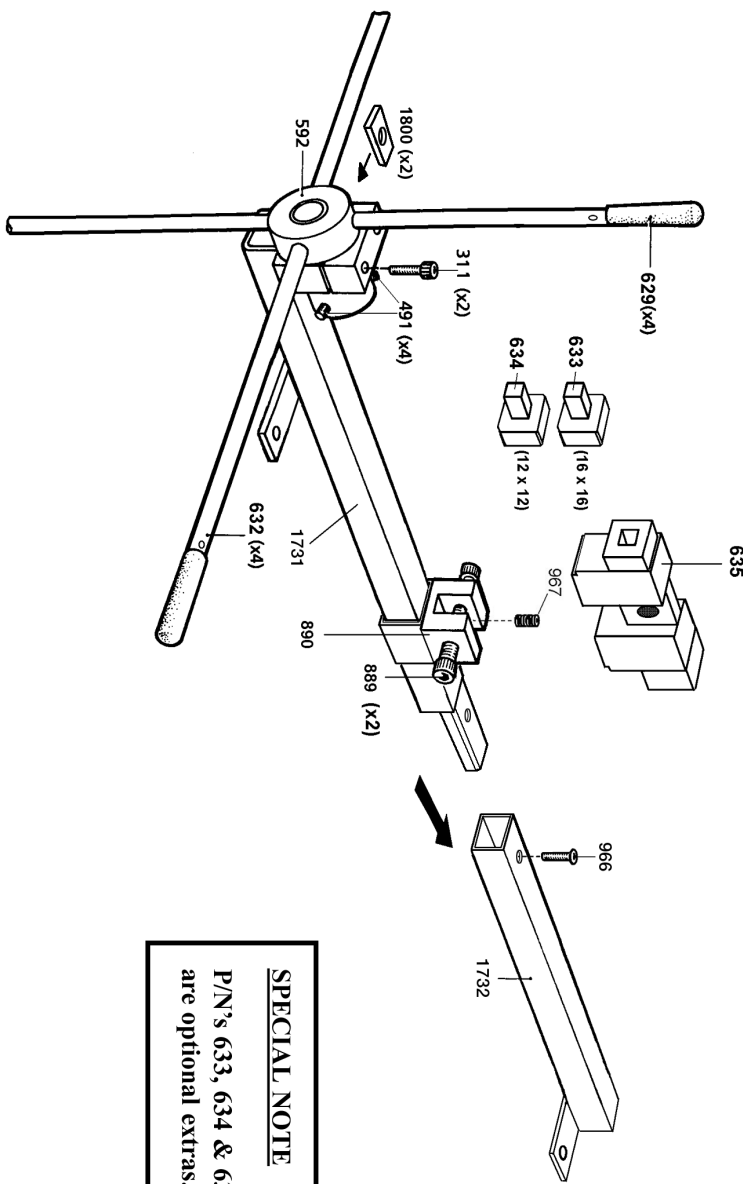

SPECIAL NOTE
P/N's 633, 634 & 635 are optional extras.

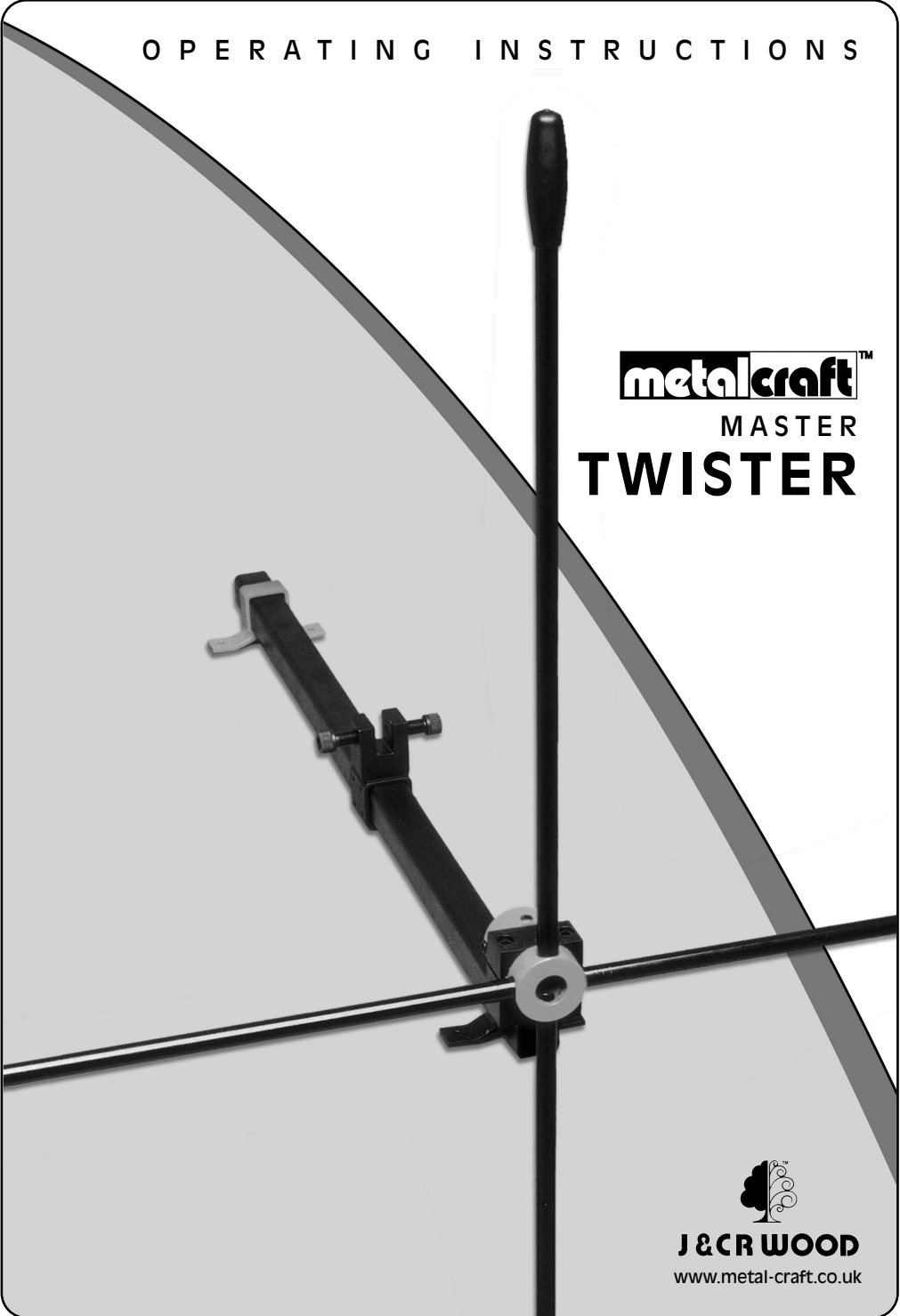

J & C R WOOD

66 CLOUGH ROAD, HULL HU5 1SR • TEL: 01482 345067 • FAX: 01482 441141
email: info@jandcrwood.co.uk • www.metal-craft.co.uk

Issue 1
19/05/06

Copyright of J&C R Wood 1994. All rights reserved. No part of this publication may be reproduced by whatever means without prior written permission of J&C R Wood.

M A S T E R TWISTER

Please keep these instructions in a safe place for any future reference to the parts diagrams.

IMPORTANT - Ensure all moving parts are regularly lubricated and all bolts kept tightened.

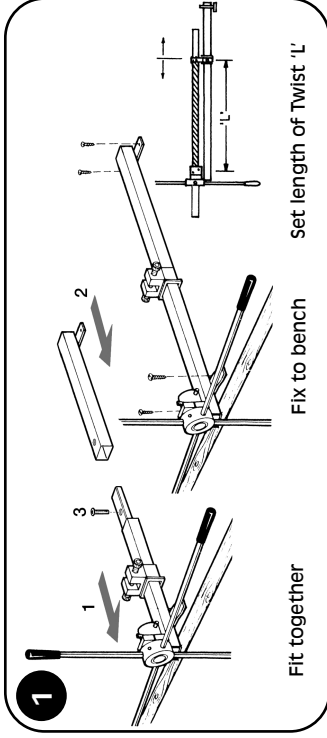

Fit together

Fix to bench Set length of twist 'L'

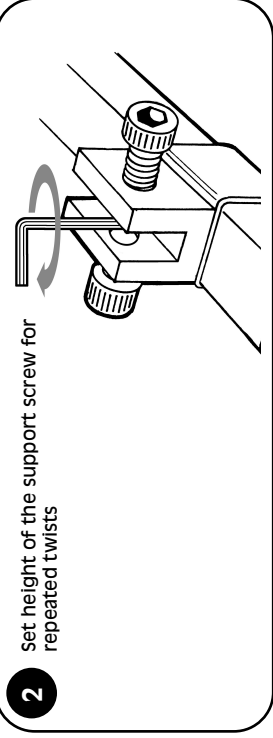

Set height of the support screw for repeated twists

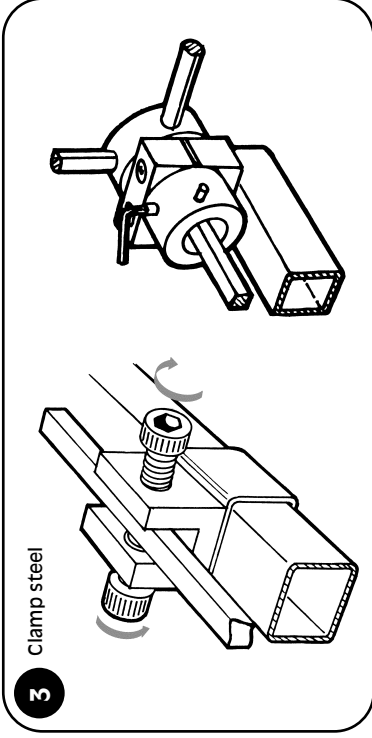

Clamp steel

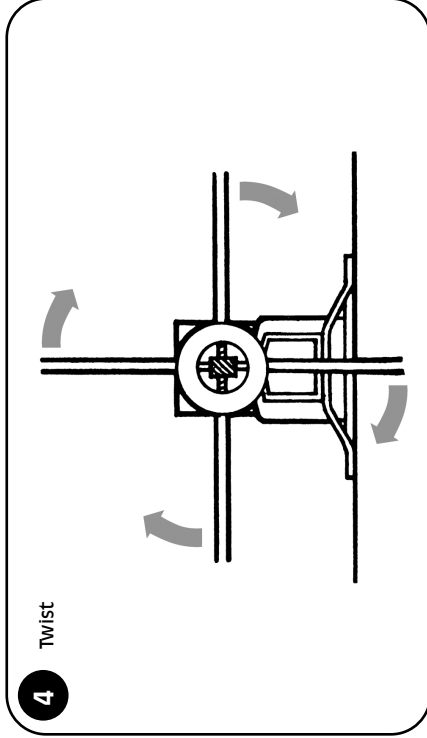

Twist

CAPACITIES

MASTER	MAX. SIZE METAL		LENGTH	
	MIN.	MAX.	MIN.	MAX.
	25mm x 10mm	16mm x 16mm	45mm	980mm

NOTE:
1) These sizes are for Hot Rolled Black Mild Steel Bar & Annealed Bright Mild Steel Bar.

2) Working beyond the capacities stated above or with materials of greater strength or hardness will reduce the operational life of the machine.

DUE TO A POLICY OF CONTINUAL DEVELOPMENT & IMPROVEMENT THE COMPANY RESERVE THE RIGHT TO MODIFY METALCRAFT TOOLS WITHOUT PRIOR NOTIFICATION.

INSTRUCTIONS FOR PRODUCING DECORATIVE 'BASKETS'

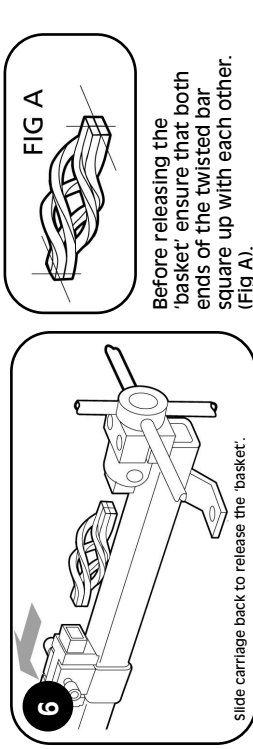
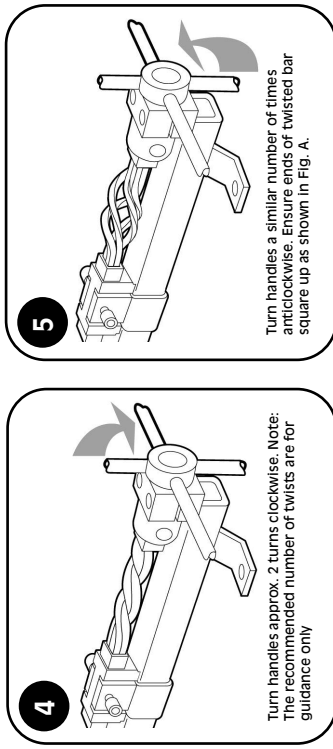
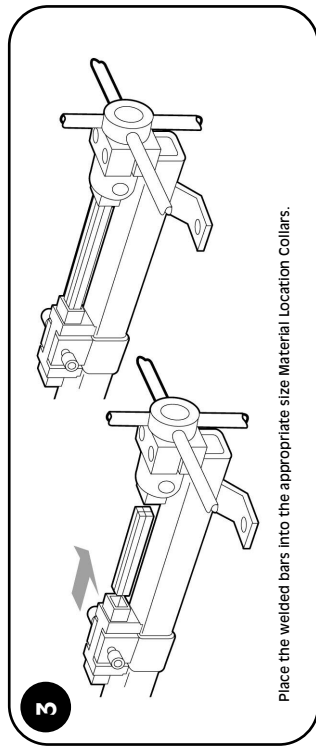
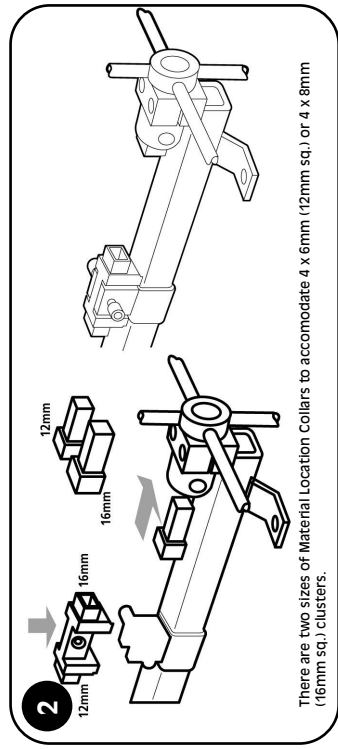
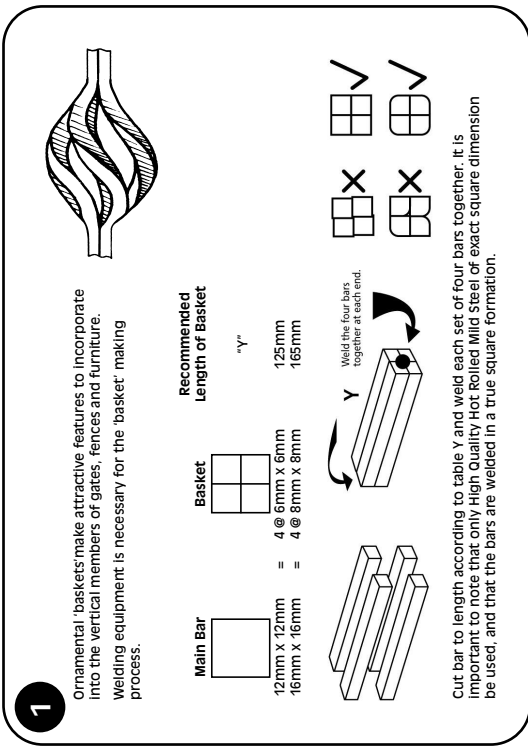

FIG A

Before releasing the 'basket' ensure that both ends of the twisted bar square up with each other. (Fig A).

IMPORTANT NOTE:

Due to the fluctuations in the temper of steel along its length, no guarantee can be given as to the consistent forming of the 'basket' shape.